

BIO-REGIONAL 3.0 – OUTLINE



V0.1 for 27-05-21

Greetings – you are invited to the **Bio-regional 3.0** – a leading **Conversation** in the ‘Laboratory for collective intelligence’.

The *bio-region 3.0* concept is based on a ‘collective bio-regional intelligence’, with mutual learning and co-production from a *wider* community and *deeper* layers of value...

Date: Thursday 27th May – timing for Europe / N. America axis (BST times)

- (1645 - virtual coffee at the 3D Eco-wise garden - <https://hubs.mozilla.com/meeV34u>)
- 1700-1830 – panel discussion & dialogue
- 1830-1930 – interactive workshop with potential co-authors
- (1930 - virtual cocktails at the 3D Eco-wise garden –

Panel: Alberto Mataran (Univ Granada): David Fanfani (Univ Firenze): Amy Lerner / Keith Pezzoli (UCSD): Adriana Arias / Jorge Arrendondo (UABC Mexicali): Rob Thayer (UC-Davis): Gianluca Brunori (Univ. Pisa): Daniela Poli (Univ. Florencia): Joe Ravetz (coordinator - Univ of Manchester).

IN a world of climate chaos and global disruption, the bio-regional seems the way to go – with a circular economy of resources, food-health democracy, sustainable ecosystems which avoid future pandemics, and liveable communities.

But – all around, powerful forces push in other directions – global finance and supply chains, international migration, extraction and privatization of water / energy / materials... Meanwhile city-regions and peri-urban sprawl face every kind of natural disaster – fire, flood, drought, heat, storm, tide and cyclone.

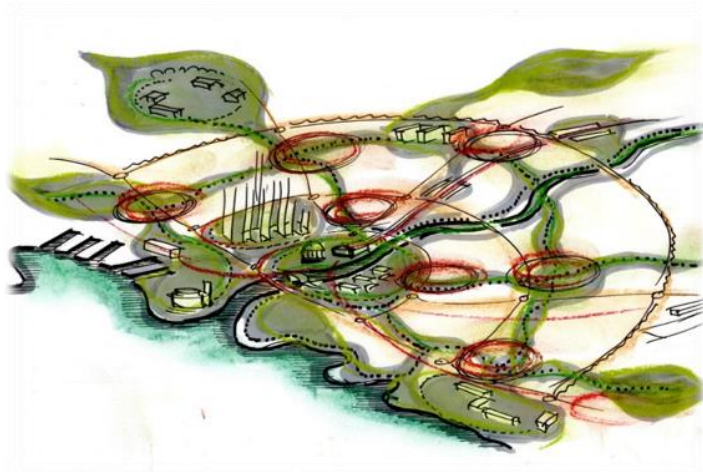

So the bio-region has never been so crucial and so challenging. We need to raise the game, to explore the potential of social innovation, policy learning, social-eco-enterprise, all adding up to a ‘collective bio-regional intelligence’. So this workshop focuses on key questions –

- How would a **bio-regional 3.0** work in practice on the ground?
- What are the possible implications of the pandemic & what can we learn from this?

- Which pathways could lead towards such a **bio-regional 3.0**?
- how to take it forward: funded research, publication (book / special issue / other), policy development?

Previous work:

- this work builds on the edited book – **Bio-regional planning & design**
- also the new book [Deeper-City-Collective-Intelligence-and-the-Pathways-from-Smart-to-Wise](#)
- the work of the San Diego Centre – <https://bioregionalcenter.ucsd.edu/>
- a scoping session at UABC Mexicali - <https://www.facebook.com/fadmexicali/>
- previous workshop in this series - [Green new deal 3.0](#)

Materials: background and related events: [bio-regional & eco-urban materials](#)

Registration: <https://www.eventbrite.com/e/bio-regional-30-tickets-145276593201>

We look forward to discussion leading towards action...

BIO-REGIONAL 3.0 - CONCEPTS

Here are some notes on the meaning and the practice Bio-regional 3.0 , drawing on the synergistic methods and example pathways from the peri-urban project <http://peri-cene.net> and the new book: [Deeper-City-Collective-Intelligence-and-the-Pathways-from-Smart-to-Wise](#)

The first challenge of any bio-regional model is to emerge and survive, against the massive challenges of globalization and extraction - financial, political, social, technological etc. To do this we look wider, further and deeper;

- **Wider communities** of stakeholders are involved – beyond the usual elite of political economic & technological.
- **Further scope** of problems & responses: not only today's direct problem fix but long term, strategic, life-cycle thinking.
- **Deeper layers** of logic, meaning and value: beyond the technical and economic calculus, to include social, psychological, cultural and of course ecological – see below.

Then we can explore different modes of system organization, not only material but cognitive (building on ecological complexity, panarchy, dynamic adaptive systems):

- **'Bio-region 1.0'** takes a linear frame for problems and solutions: looks for direct cause-effect linkages (for example the flows of material resources and recirculation at the regional level);
- **'Bio-region 2.0'** follows an **evolutionary** frame of problem and solution: one of markets, innovation and survival of the fittest (e.g. for a circular economy to work in practice needs incentives, competitions, etc).
- **'Bio-region 3.0'** takes a co-evolutionary linear frame of problem and solution: where a **collective bio-regional intelligence** can enable learning, strategic thinking, innovation and co-production, between a

wider stakeholder community, for **further** horizons, with **deeper** layers of meaning & value. (e.g. for a circular economy to work, and provide economic returns, social livelihoods and ecological stewardship, needs all such values to be integrated).

This **Bio-region 3.0** model can then be applied to **deeper** system layers – here summarized in the ‘STEEPUCU’ format -

- **Social** systems – new forms of social learning and enterprise, community development;
- **Technical** systems – potential for digital enabled platforms, finance, socio-eco value chains;
- **Economic** systems – producer-consumer cooperatives, inter-generational markets, socio-eco investment;
- **Ecological** systems – multi-scale adaptive ecosystem diversity, agro-ecology & forestry, permaculture;
- **Political** systems – participative inclusive multi-level governance, policy & planning,
- **Cultural** systems – creative arts, archetypes & myths, eco-education
- **Urban-territorial** systems – finally the inter-connection of urban, peri-urban, rural & global hubs with local & bio-regional principles.

PATHWAYS FROM HERE TO THERE

A **pathway** is generally a linked set of actions and knowledge, which over time can move towards a desired goal – systems change leading to transformation.

- A **functional pathway** is about tangible problems with direct solutions: e.g. building a flood defence wall for a known extreme event.
- An **adaptive pathway** (or ‘*synergistic pathway*’) responds to real-life challenges: with typical risks and uncertainties, controversies and conflicts, social inequalities & traumas, events and contingencies, corruption and other structural barriers. To respond and succeed in the face of such challenges, we need to grow the **collective intelligence**: this includes mutual learning, co-creation and co-production, between a **wider** community, with a **further** scope of causes-effects, and with **deeper** layers of value and meaning.

These are examples in progress with the peri-urban project <http://peri-cene.net>

- **Socio-ecological-finance pathways**, (Manchester, UK): new forms of business model for green space & landscape management, linked to national Environmental Land Management program
- **Agro-ecological-democracy pathways**: new patterns of farm production, distribution & consumption, based on rural livelihoods combined with climate adaptation (Andhra Pradesh, India):
- **Eco-urban micro-design pathways**: new forms of decentralized water capture & cooling for arid climates with extreme heat, (Doha);
- **Socio-eco governance for stewardship pathways**: new forms of grassroots consensus & synergy forming for peri-urban planning & ecological land management (Toronto, CA).

OUTSTANDING QUESTIONS INCLUDE:

- How to draw the boundaries of a bio-region (clear in some cases but not in many others)?
- How to include for urban centres / agglomerations, generally a result of national / global dynamics?
- Should a circular economy be multi-scaled, from local to global, whichever is more effective?
- How to include for specialization or comparative advantage e.g. in agriculture or manufacturing? (is a world of bio-regions really a bio-world??)
- If markets alone are not enough to organize the production of bio-regional resources, what kind of governance can best do this?

PROGRAM NOTES:

We aim for a collaborative meeting of minds – not only talk but a process leading towards action... a *Collaboratorium / Lab for collective intelligence* at the frontiers.

Part 1: Link - <https://zoom.us/s/7977052056>

- JR will introduce. We have 5-10 minutes (10 max) per panel speaker, as the session is all about synergies & inter-connections.
- Great if the panel can send slides before, so we can mount them in the workspace.
- Great if the panel can address the 3 questions as far as possible, from your perspective, with examples.

Part 2: the core of the project (but optional for busy people...). here we work from the presentations, to critique & debate, to a set of pilots for R&D testing. For this we use a unique 1-2-3 combination:

- **1D** – standard chat lines & text
- **2D** – online whiteboard – link to follow
- **3D** – a unique experimental virtual space, the *Eco-wise garden* - <https://hubs.mozilla.com/meeV34u>